

Mess-Anschluss-Platte NG 10 (Zwischenplatte) Anschluss in A + B

MPZ-10.-A+B-B..

Gewicht: ca. 0.5 kg (A)
ca. 1.4 kg (S)

Nenndruck: 250 bar (A)
350 bar (S)

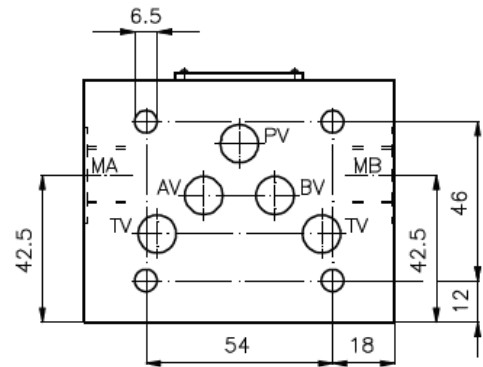
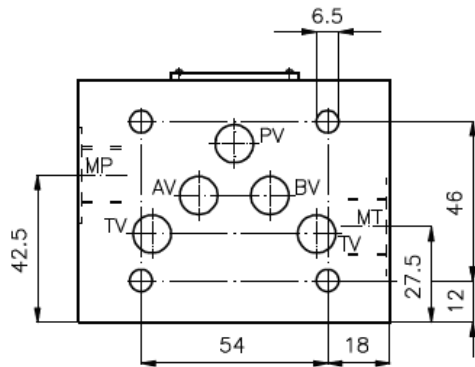

Dichtungstraeger mit
einvulkanisiertem
O-Ring (Viton FPM)
gehört zum
Lieferumfang

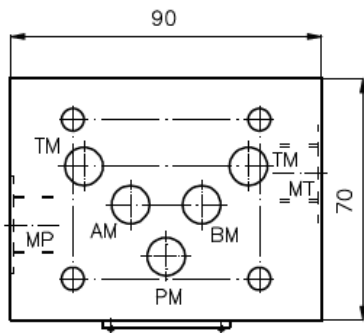
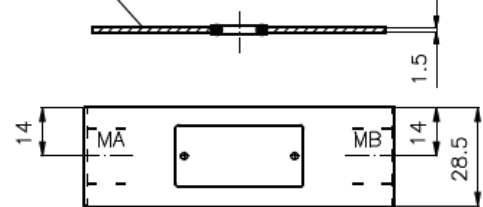
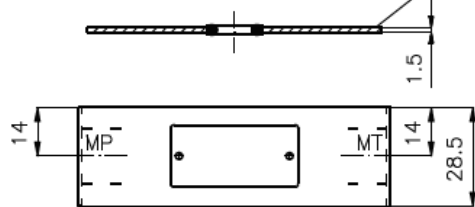

MPZ-10.-P-B..
MPZ-10.-P+T-B..

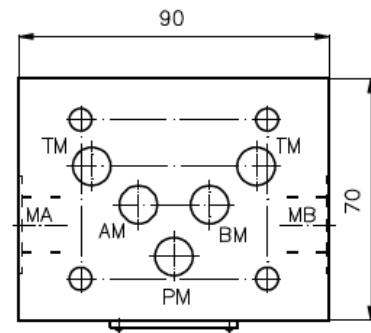

MPZ-10.-A+B-B..

Symbol: MPZ-10.-P-B02 (G 1/4")
MPZ-10.-P-B03 (G 3/8")

MPZ-10.-P+T-B02 (G 1/4")
MPZ-10.-P+T-B03 (G 3/8")

MPZ-10.-A+B-B02 (G 1/4")
MPZ-10.-A+B-B03 (G 3/8")

